



Modeling League County Competitions Models

Complexity of the model

- Simple models
- Agreement with the county commissioner
- 3-4 plywood per model
- The material is linden or poplar plywood with a thickness of 3 mm

Contest templates



- Self-adhesive paper A4
- CNC laser template
- „Dirty" the stickers



Scoring

- The preparation of the workplace
- Orderliness of the workplace during work
- Organization of work (division of tasks)
- Organization of accessories and tools
- Handling of tools and machines
- Application of safety rules at work
- Functionality of work and precision of finishing
- Additional points for any functional upgrade
- The aesthetic upgrade

Scoring table

	A	B	C	D	E	F	G	H
1	<div> HRVATSKA ZAJEDNICA TEHNIČKE KULTURE</div> <div>SCORE LIST MODELING LEAGUE 2023./2024.</div> <div> MODELARSKA LIGA</div>							
2	TEAM NUMBER	WORKPLACE ORGANIZATION (5 POINTS)	CORRECT USE OF TOOLS AND MACHINES AND APPLICATION OF PROTECTION AT WORK (10 POINTS)	PRECISION AND ORDERLY CREATION OF THE WORKPLACE POSITION (10 POINTS)	PRECISION AND ORDERLY JOINING OF THE WORKING POSITION (10 POINTS)	FUNCTIONALITY (10 POINTS)	INNOVATION AND DESIGN OF THE FINISHED PRODUCT (5 POINTS)	IN TOTAL (50 POINTS)

Examples of models

- Model description
- A few pictures of the finished model or Assembly drawing
- Operation list
- Templates in scale 1:1

Trash can; pictures of the finished work



Trash can; description of the model

- The desk and its neatness often come into question after a long period of work or study.
- Trash can can help that paper scraps, pieces of pencils after sharpening, chewing gum (kaugum) or food does not remain on the table. There are many plastic examples of this technical creation, but few wooden ones modellers can create and edit none themselves.
- The work can be made from three to four plywood sheets of A4 format, 3 mm thick and sticks with a diameter of 3 mm to 4 mm and 40 mm long.
- In addition, you need: a sawing machine, self-adhesive paper (4 pieces), accessories for manual processing plywood, cordless drill and drill from 3 mm to 4 mm (depending on the thickness of the sticks) and glue for wood.

Trash can; Work procedure

- 1. Place the self-adhesive paper with the drawings on the plywood, try to weaken the glue before gluing high pressure joints with the material.
- 2. By sawing, shape and sanding to finish the position of the lid of the bucket, the grooves of the support, saw to the line, and then finish with a file to the required size (plywood thickness).
- 3. When joining by gluing the positions of the cover, first connect the top part and then the sides of the cover. After lining the lower part of the lid, place and glue the supports and the handle for opening the bucket in the grooves. It is used with hooks and rubber bands for easier and better gluing.
- 4. After the cover, shape the positions of the bucket by sawing. First saw the positions of the bottom, shape by sanding and join gluing. After that, you are left with the sides of the bucket and the top part. Saw the upper part, shape it by sanding and join by gluing. Before connecting, check the width of the groove and the thickness of the material.

Trash can; Work procedure

- 5. When all the sides, bottom and top of the bucket are ready, glue them together. Place in the slots carriers, be careful how you place them. The curves must be placed upwards. When gluing accept positions with rubber bands so that the joints are as good as possible and to make the gluing process easier.
- 6. Prepare the wand and place the lid on the bucket. The holes for the stick must match, so first mark where the hole will be on the bucket, then mark where it will be on the lid with an awl or pencil. Pass the stick through and, if necessary, connect it to the bucket supports by gluing.
- 7. When you have time, improve functionality and design.

Enjoy your work and have fun!

Trash can; Templates

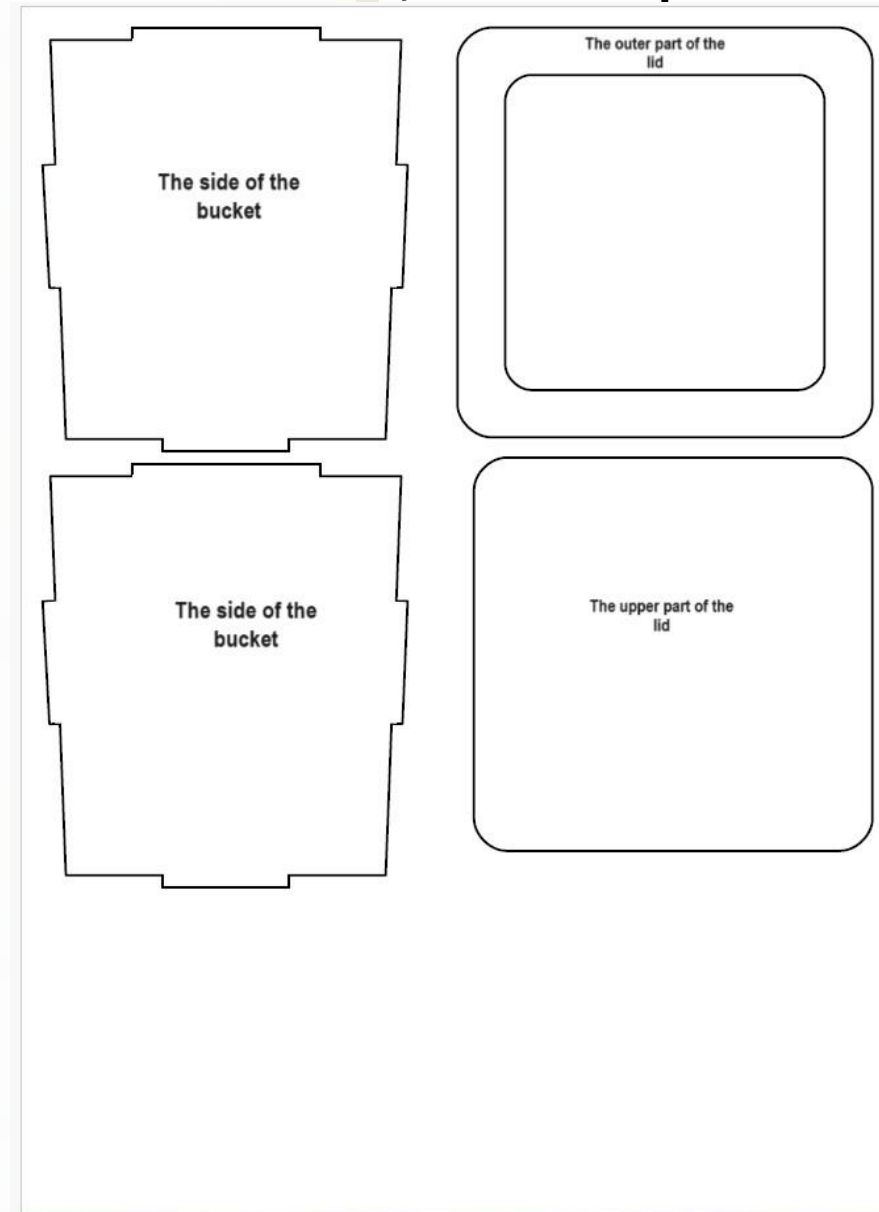

Trash can; Templates

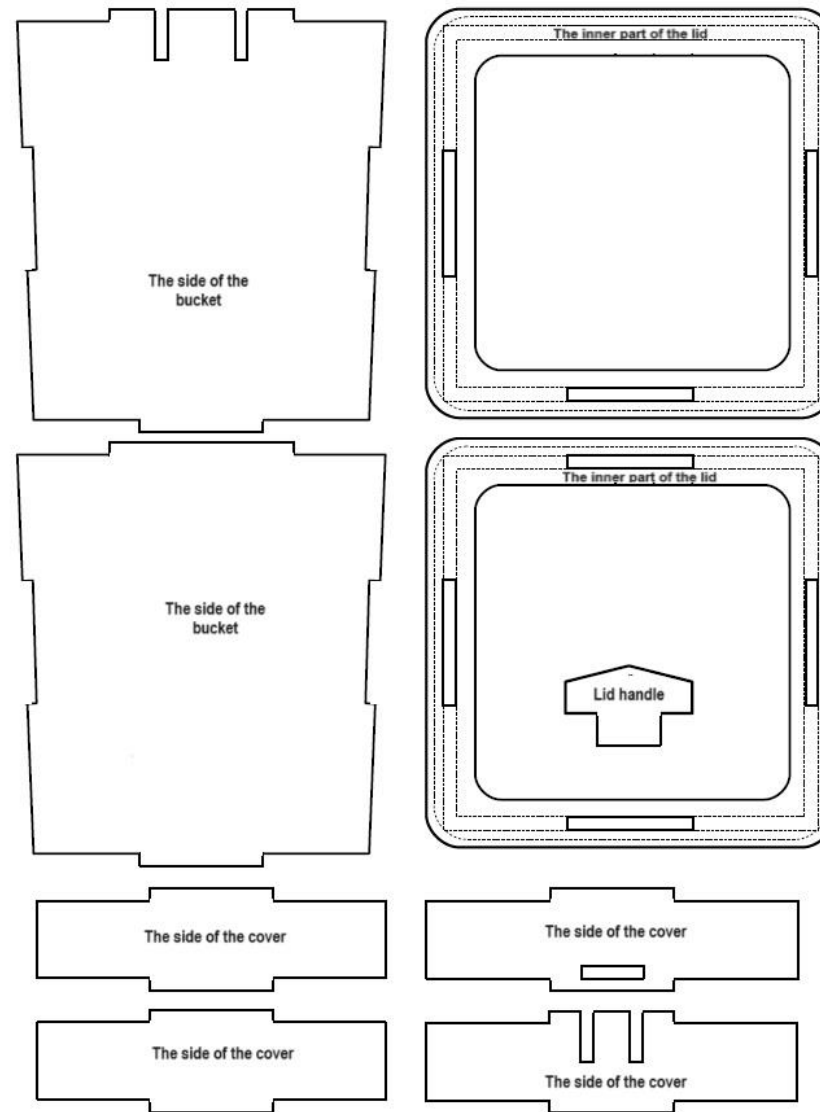

Trash can; Templates

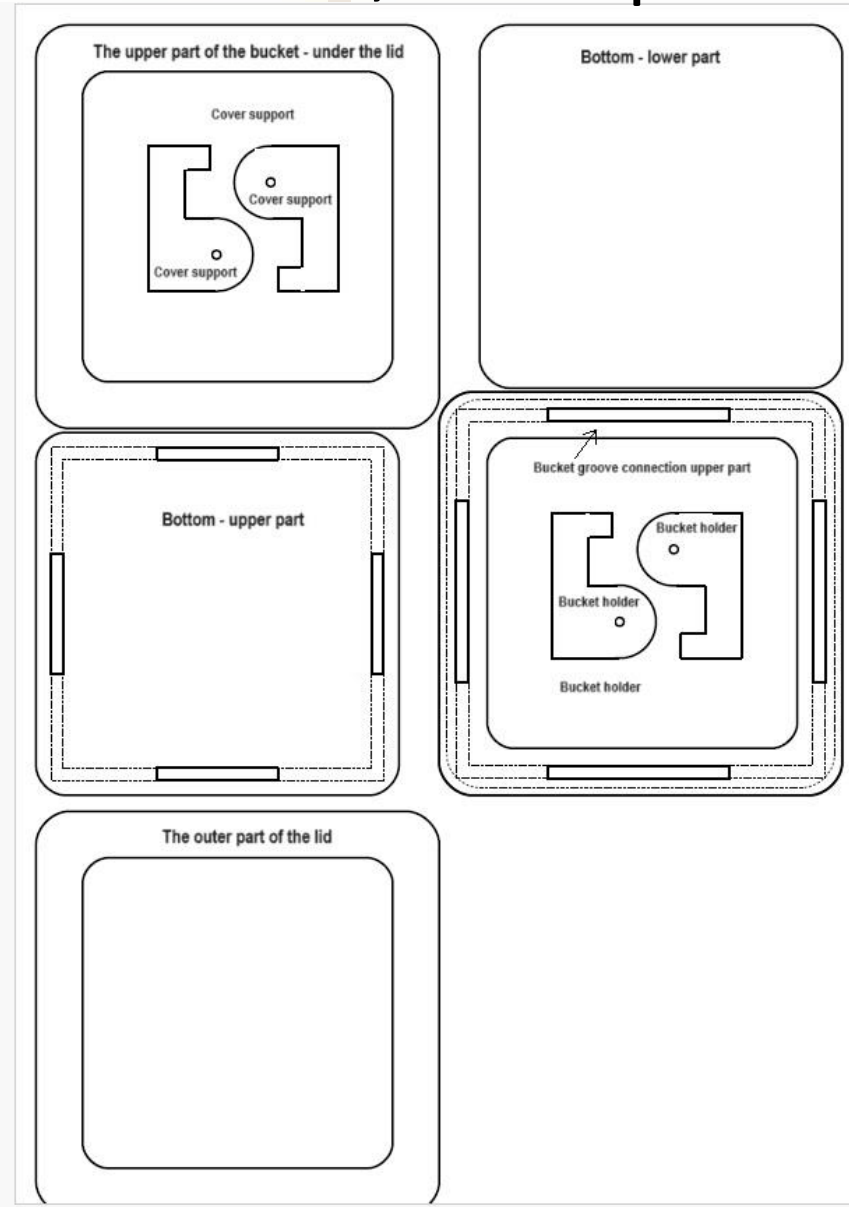

Trash can; Templates

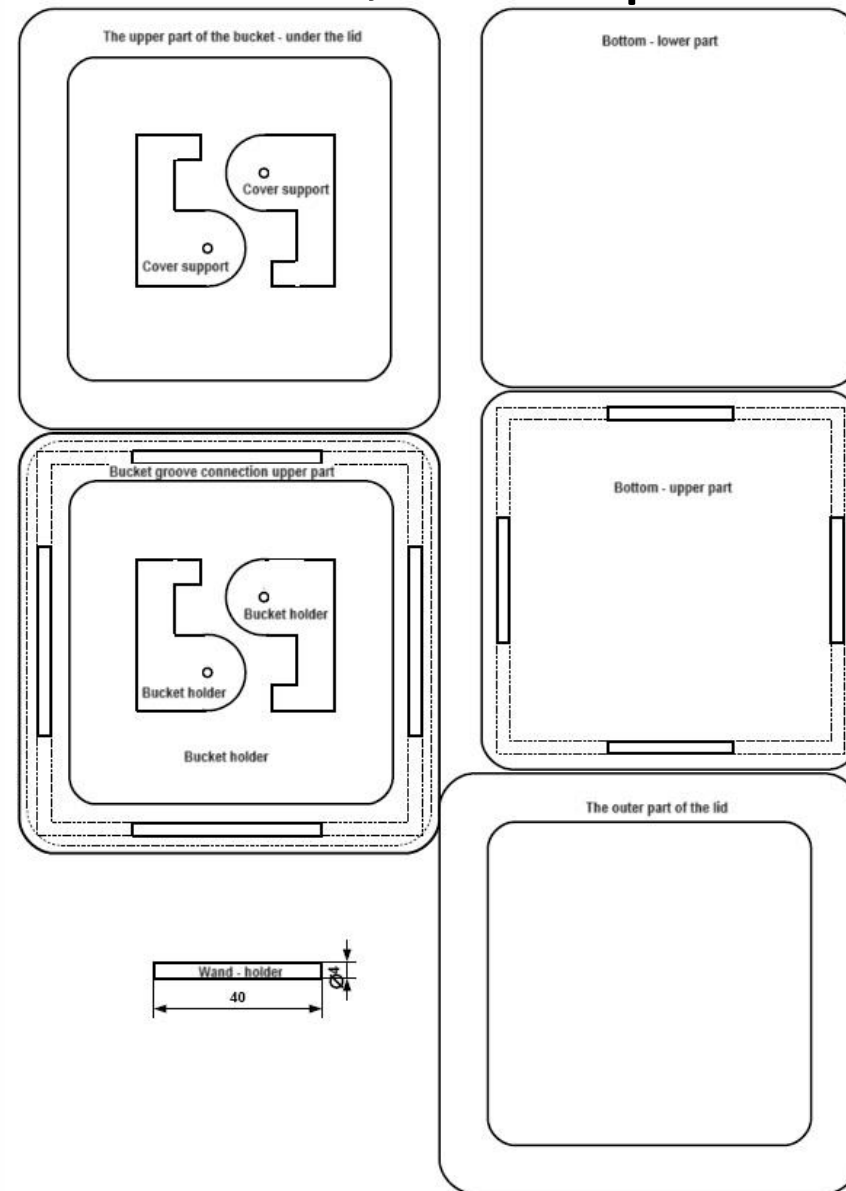

A few more models; The arbor

Sjenica

Prema sastavnom crtežu izradi sjenicu izrezujući pozicije s naljepnice. Izrezane pozicije obradi brušenjem.
Brid krova potrebno je dodatno obraditi brušenjem radi lakšeg sastavljanja.

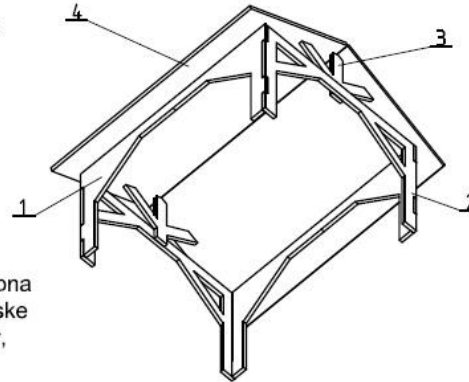
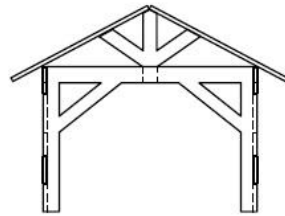

Alat:
unimat složen za piljenje, stupna
bušilica i svrdlo 3mm, ključarske
turplje, štipaljke, brusni pribor,
modelarski nožić

Pribor:
Pribor za tehničko crtanje

Materijal:
2 ploče A4 formata šperploče
debljine 3mm
2 naljepnice

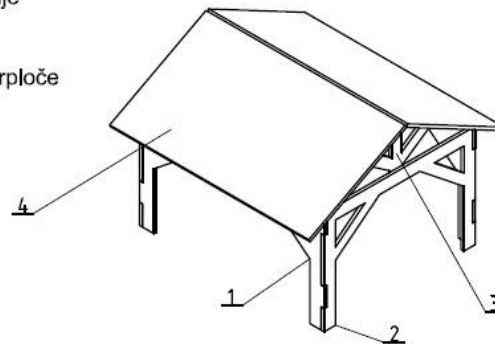

A few more models; The plane

Avion

Prema sastavnom crtežu izradi avion izrezujući pozicije s naljepnice, izrezane pozicije obradi brušenjem.
Vratilo za kotače pripremi iz štapića za roštilj. Važna je funkcionalnost kotača i elise.

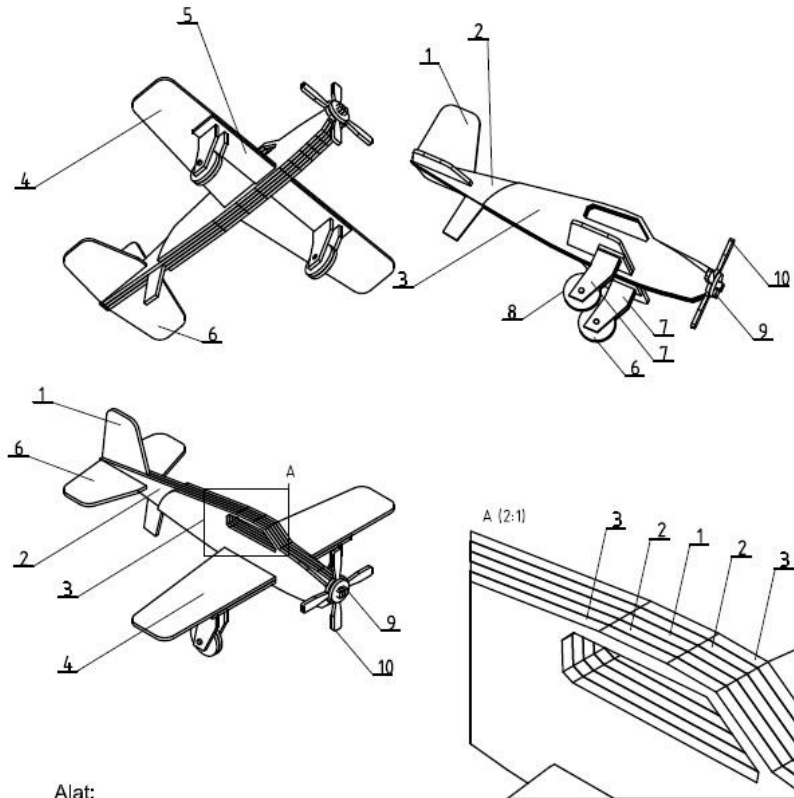

Alat:

unimat složen za plijenje, stupna bušilica i svrdlo 3mm, ključarske turplje, štipaljke, brusni pribor, modelarski nožić

Pribor:

Pribor za tehničko crtanje

Materijal:

3 ploče A4 formata šperploče debljine 3mm
štapić za roštilj 150x3mm
3 naljepnice

A few more models; The bridge

Most

Prema sastavnom crtežu izradi most izrezujući pozicije s naljepnica. Izrezane pozicije obradi brušenjem.
Obratiti pažnju na sastavljanje gornjeg dijela ukrute mosta i dodatnog brušenja brzdova radi lakšeg spajanja.

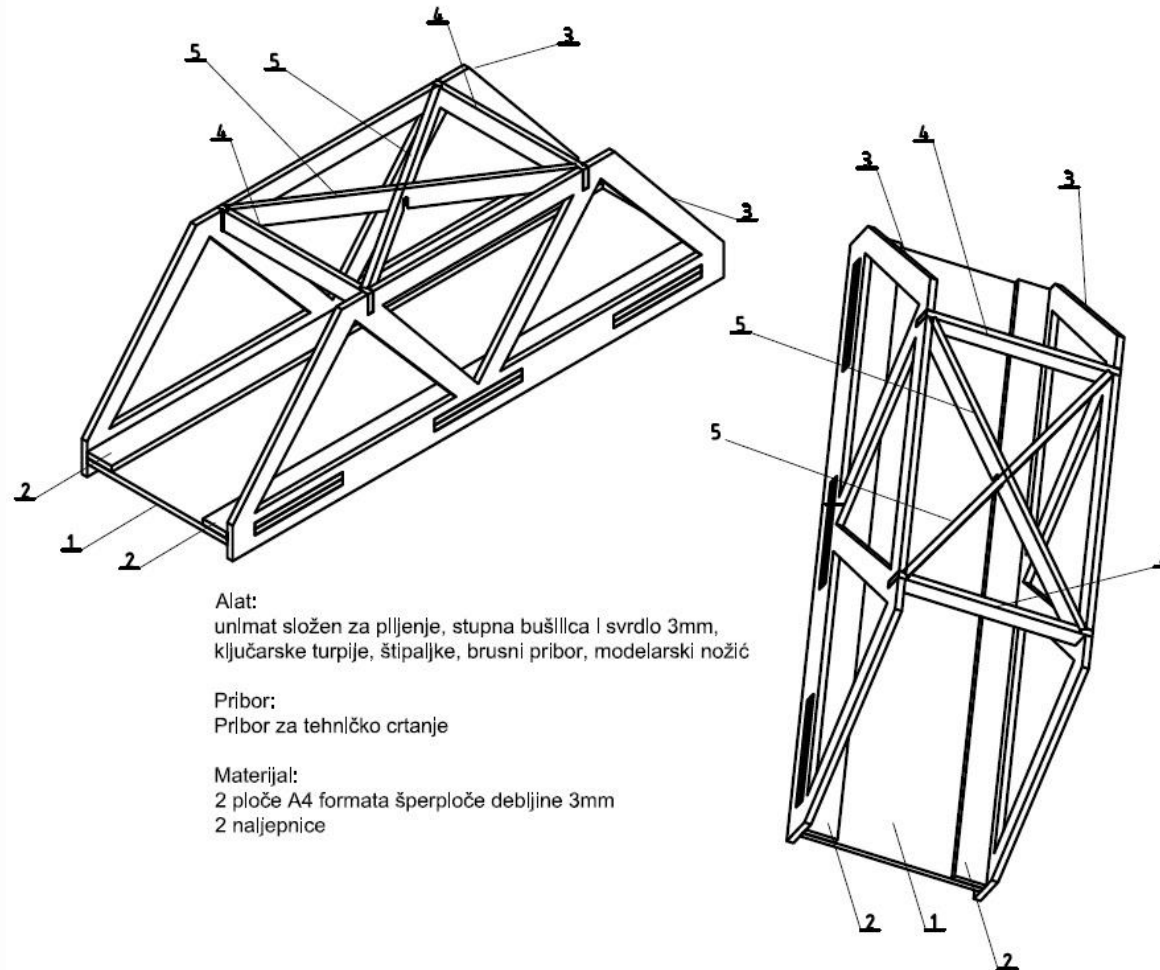

A few more models; The fence

Prema ocrtanim pozicijama izradi ogradu s vratima, na vrh ograde postavi tablu s pločom dobrodošlice i logom.

Pozicija 8 nije zadana nju kroji na gotovim vratima.

Šarke (mehanizam otvaranja vrata najlonski dio odbačene naljepnice lijepiš između slojeva 2b i 2c na jednoj strani stupa po tvom izboru, dok drugi dio lijepiš na vrata između slojeva 4a i 4b. Osim estetskog izgleda obrati pažnju na funkcionalnost. Ostatak materijala iskoristi za pliču dobrodošlice.

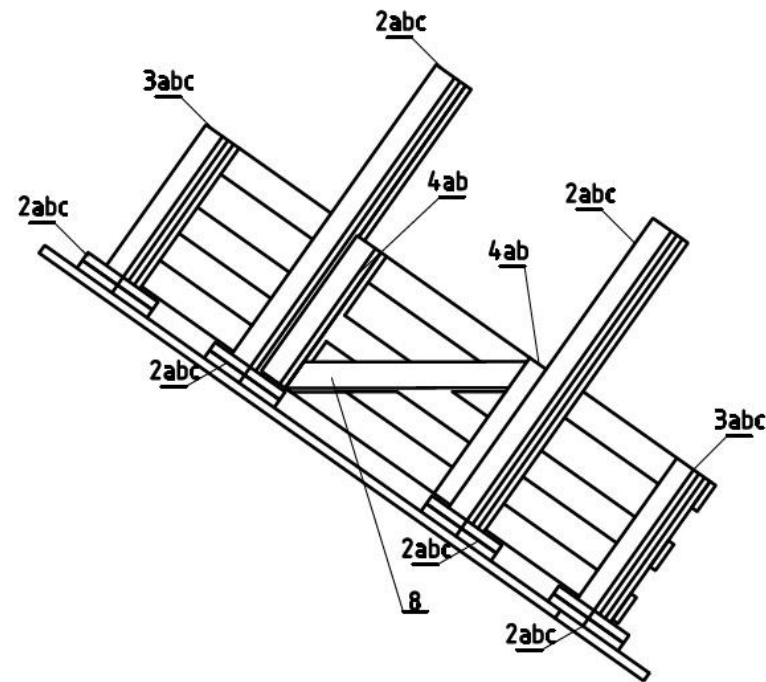
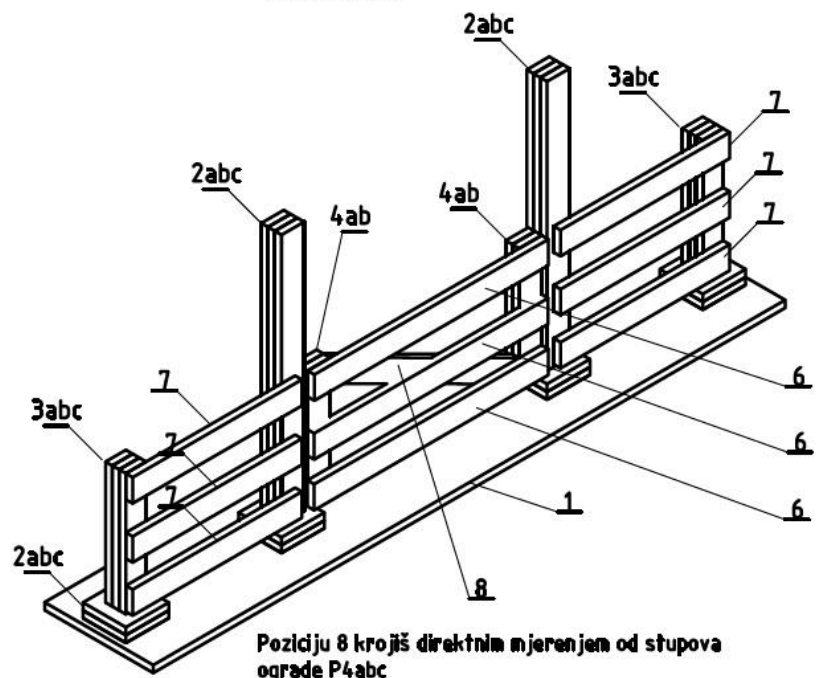



That, folks, is all for today...

Thank you for participating in the presentation
See you...

Hrvoje Vrhovski

